

BEDROOM TOP FLOOR FLAT situated in a corner block to Chingford Mount Road, within close walking distance to Chingford Mount Shops and all the major bus routes to Walthamstow Central.

CHURCHILL
estates



Frances Court, Chingford Mount Road, E4
£1,095 Per Month



To view call **020 8524 0000**
Email southchingford@churchill-estates.co.uk



Churchill Lettings are pleased to offer to let this MODERN AND ROOMY TWO BEDROOM TOP FLOOR FLAT situated in a corner block to Chingford Mount Road, within close walking distance to Chingford Mount Shops and all the major bus routes to Walthamstow Central.

The Property offers, neutrally decorated interior throughout, Lounge, Fitted Kitchen Area, Two Good Sized Bedrooms, White Bathroom Suite, Double Glazed Windows throughout, Electric Heating, and Security Intercom System. All Electric Heating.

The property is Available Now and is offered Unfurnished

Churchill Lettings are pleased to offer to let this MODERN AND ROOMY TWO BEDROOM TOP FLOOR FLAT situated in a corner block to Chingford Mount Road, within close walking distance to Chingford Mount Shops.

The flat has been recently decorated, the accommodation offers, RECEPTION AREA, FITTD KITCHEN AREA, TWO BEDROOMS, WHITE BATHROOM, ALL ELECTRIC HEATING,

OFFERED UNFURNISHED AND AVAILABLE NOW.

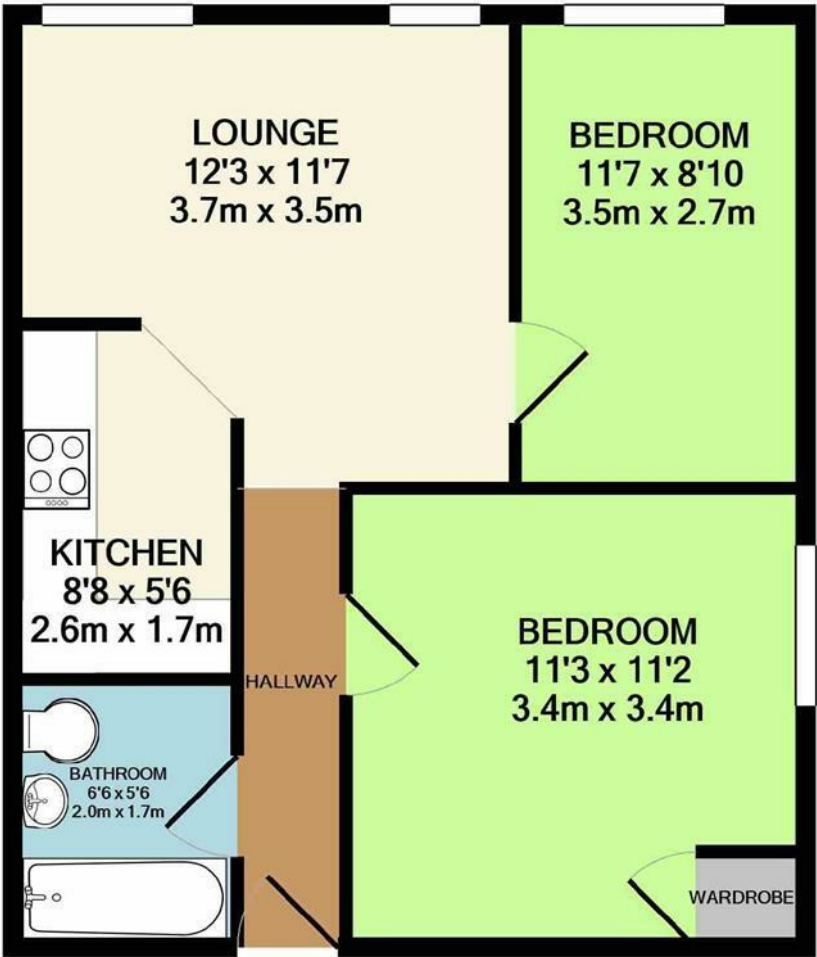

TOTAL APPROX. FLOOR AREA 440 SQ.FT. (40.9 SQ.M.)

Whilst every attempt has been made to ensure the accuracy of the floor plan contained here, measurements of doors, windows, rooms and any other items are approximate and no responsibility is taken for any error, omission, or mis-statement. This plan is for illustrative purposes only and should be used as such by any prospective purchaser. The services, systems and appliances shown have not been tested and no guarantee as to their operability or efficiency can be given
Made with Metropix ©2020

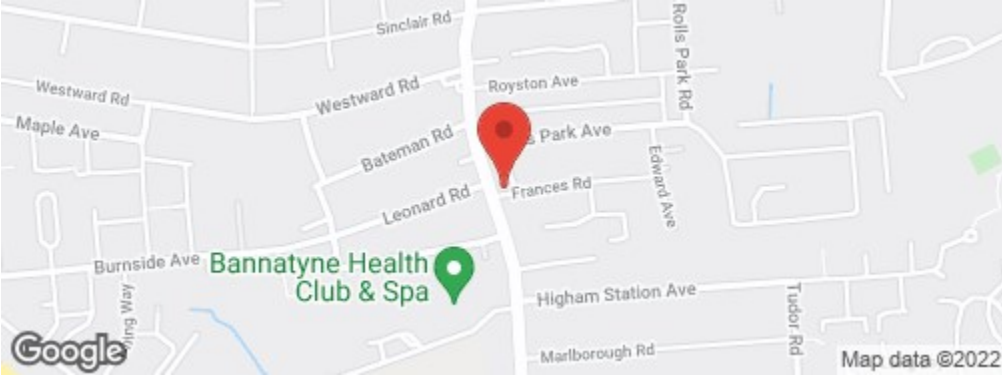
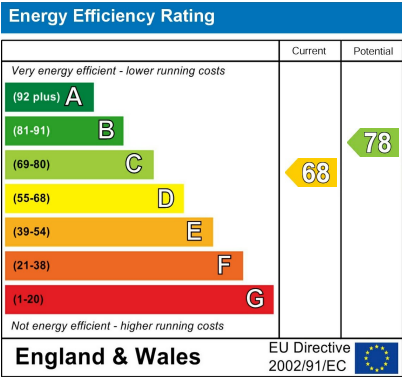

The Agent has not tested any apparatus ,equipment, fixtures and fittings or services and so cannot verify that they are in working order or fit for the purpose. A buyer is advised to obtain verification from their solicitor or surveyor.
References to the tenure of a property are based on information supplied by the seller. The agent has not had the sight of the title documents. A buyer is advised to obtain verification from their solicitors.

CHURCHILL
estates

To view call **020 8524 0000**
Email southchingford@churchill-estates.co.uk